

Classroom Yes!

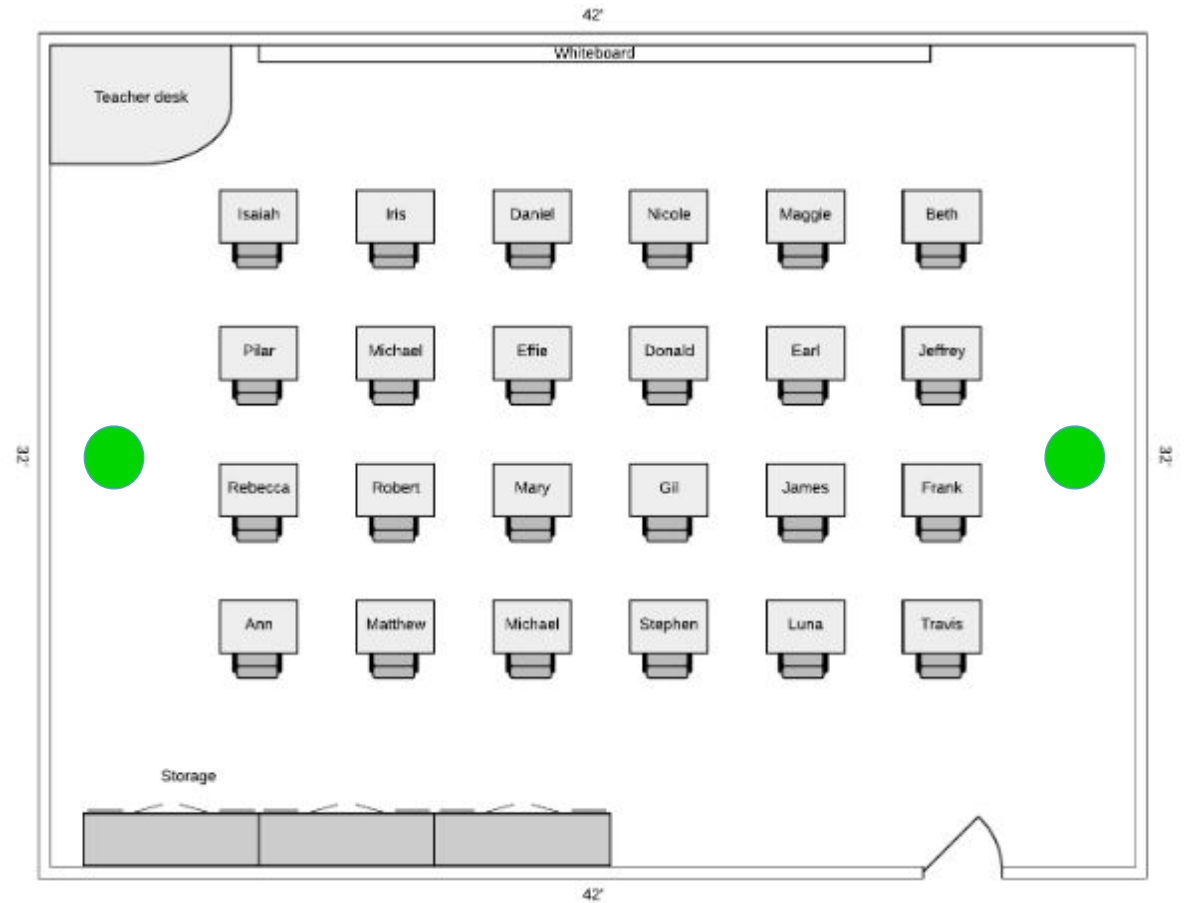

1. Located on opposite corners or sides provides good airflow and coverage of entire classroom.
2. Not interfering with doors or obstructions.

Classroom **No!**

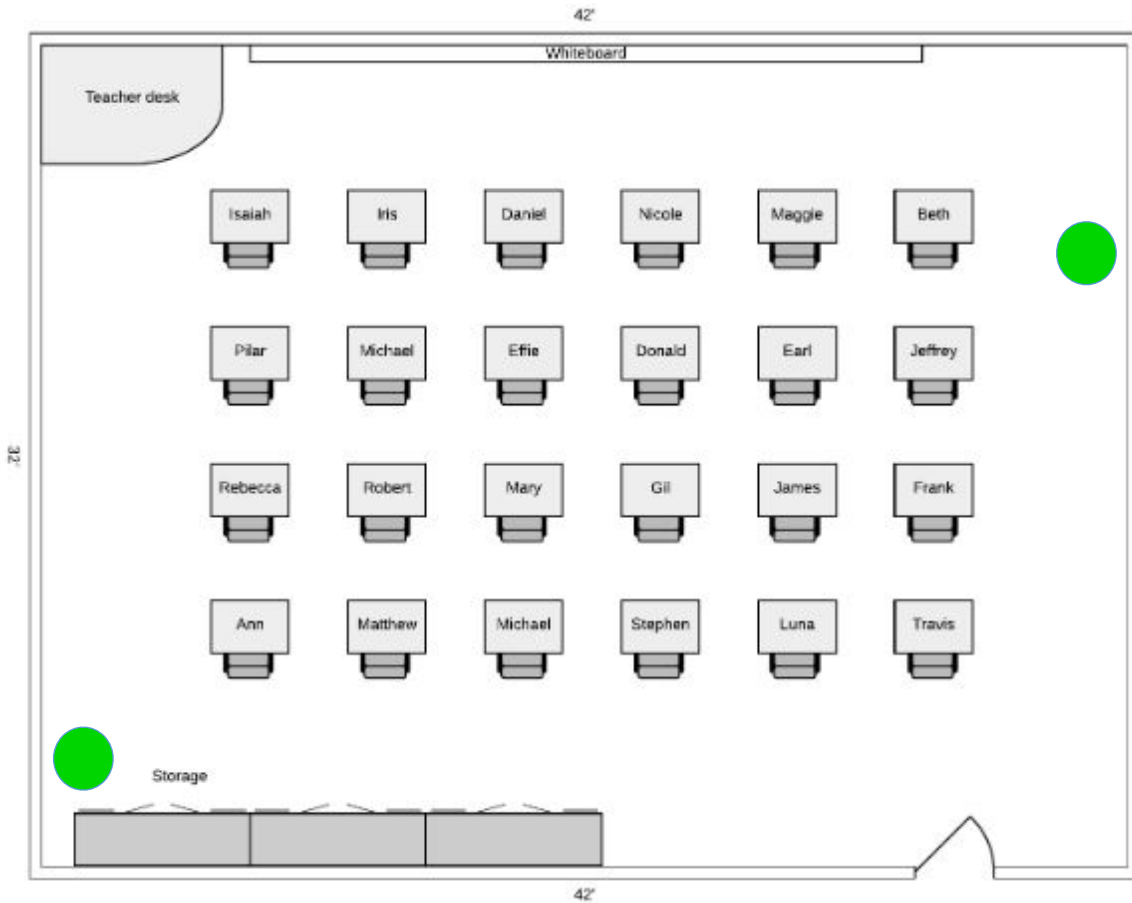
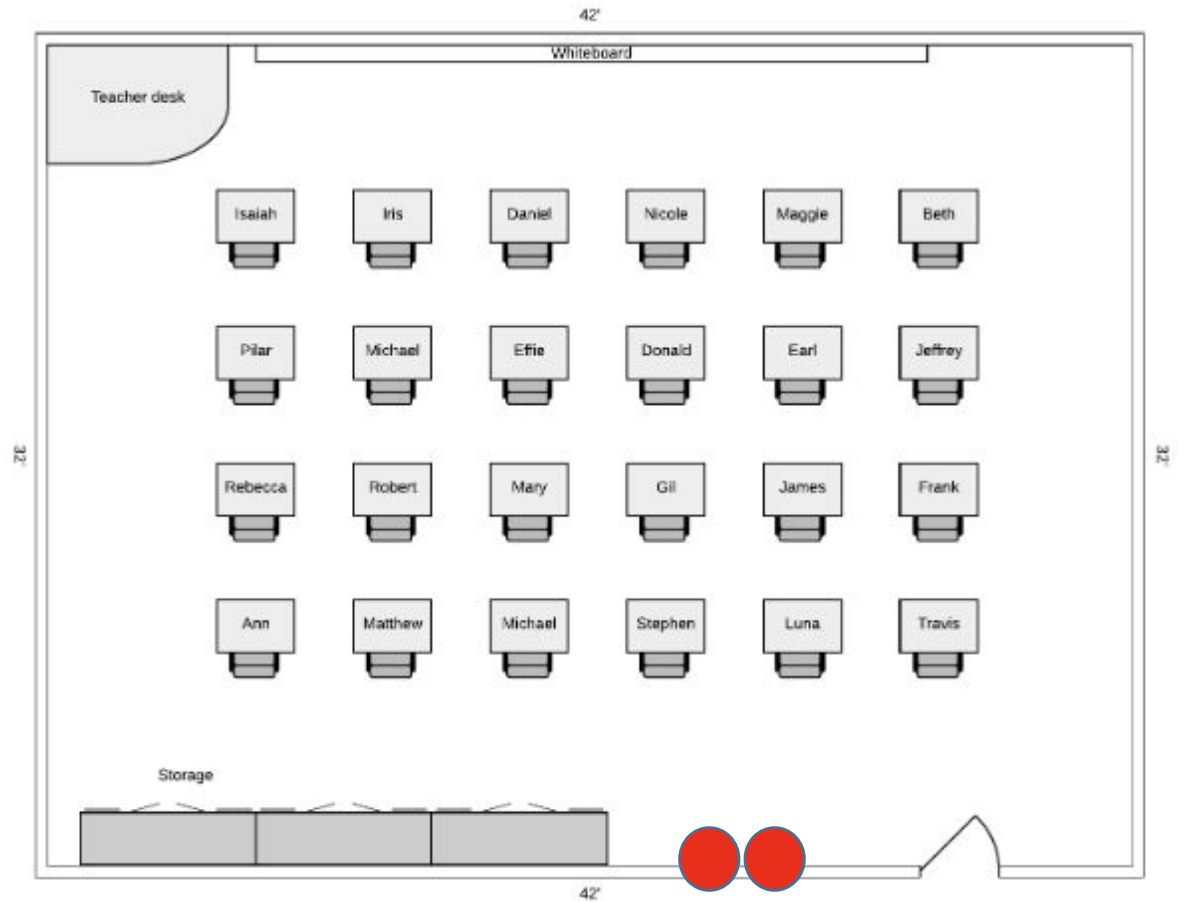
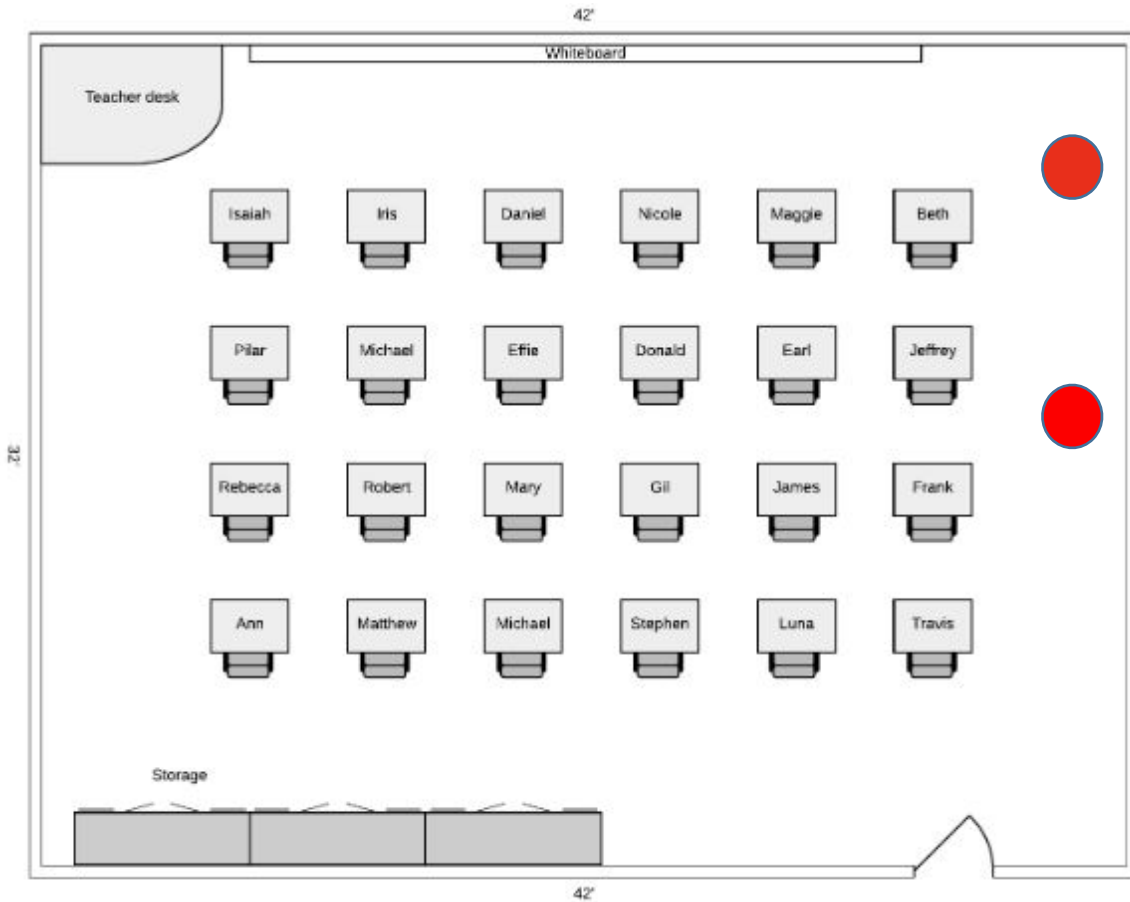

1. Located next to each other or only on one side reduces coverage of entire classroom.

Cafeteria Yes!

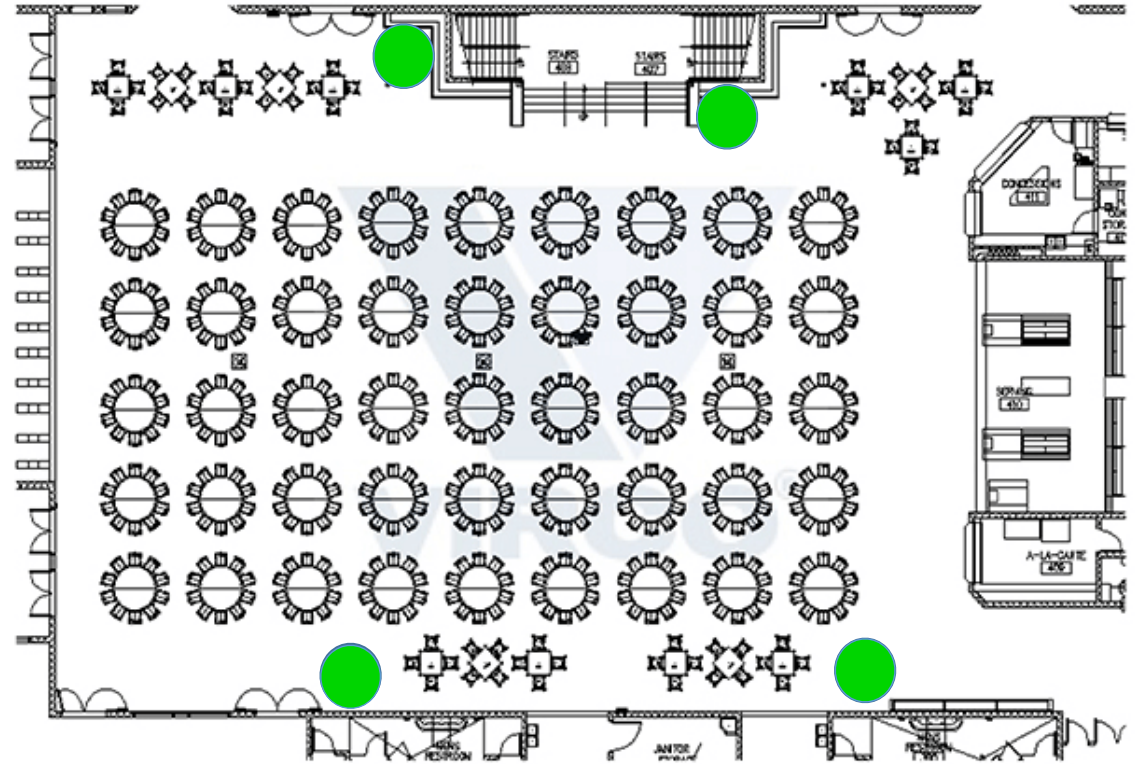
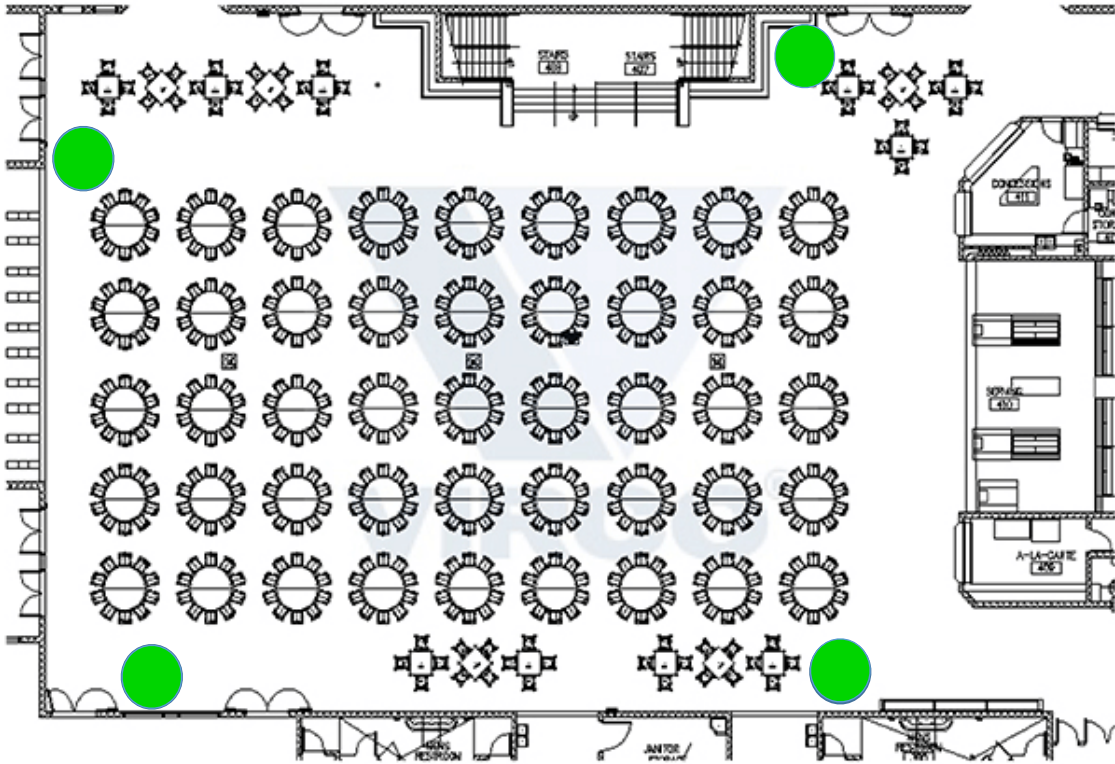

1. Located on opposite corners or sides provides good airflow and coverage of entire cafeteria.
2. Not interfering with doors, obstructions or high traffic areas.

Cafeteria **No!**

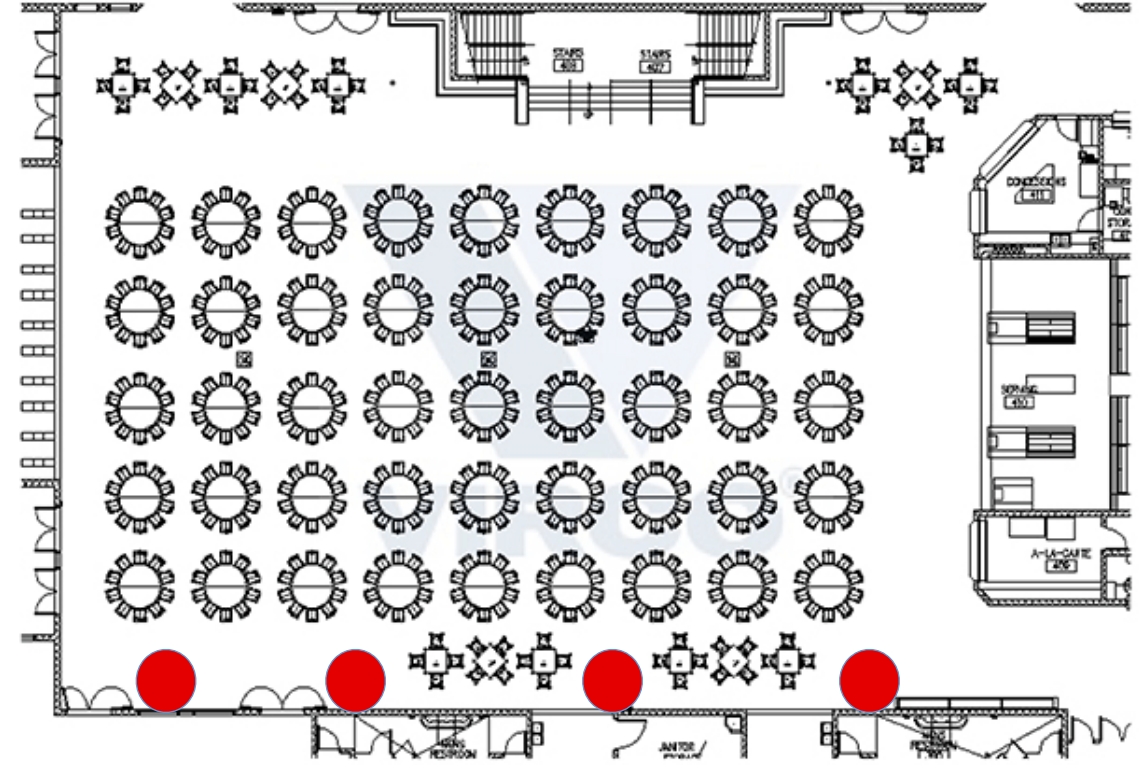
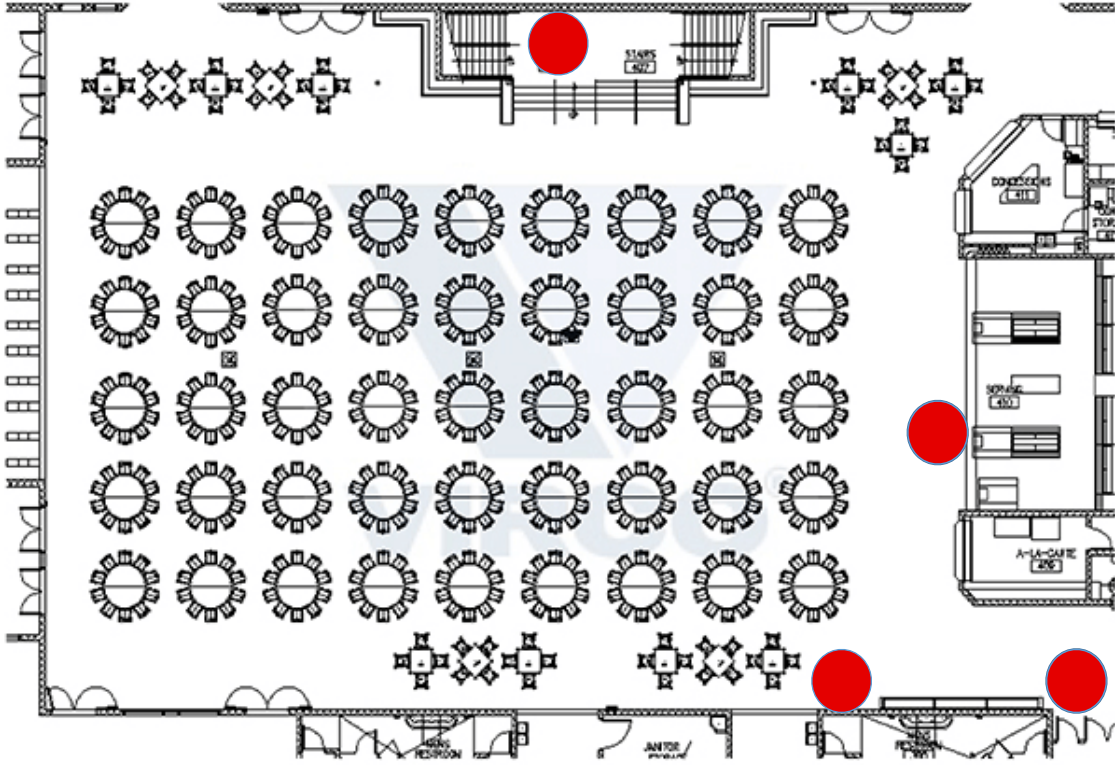

1. Located on the stairs could present a safety issue.
2. Located next to each other or only on one side reduces coverage of entire cafeteria.
3. Located at the cash registers or food pick-up could create an obstruction.

Teacher Lounge Yes!

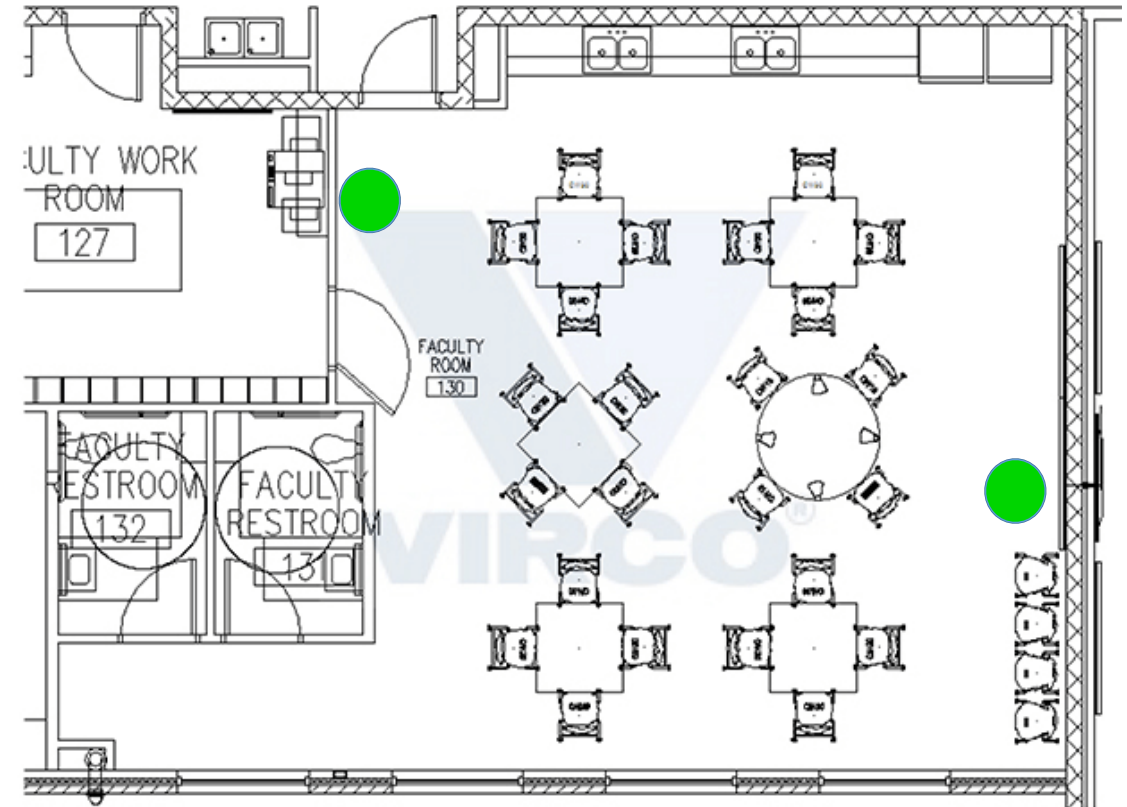
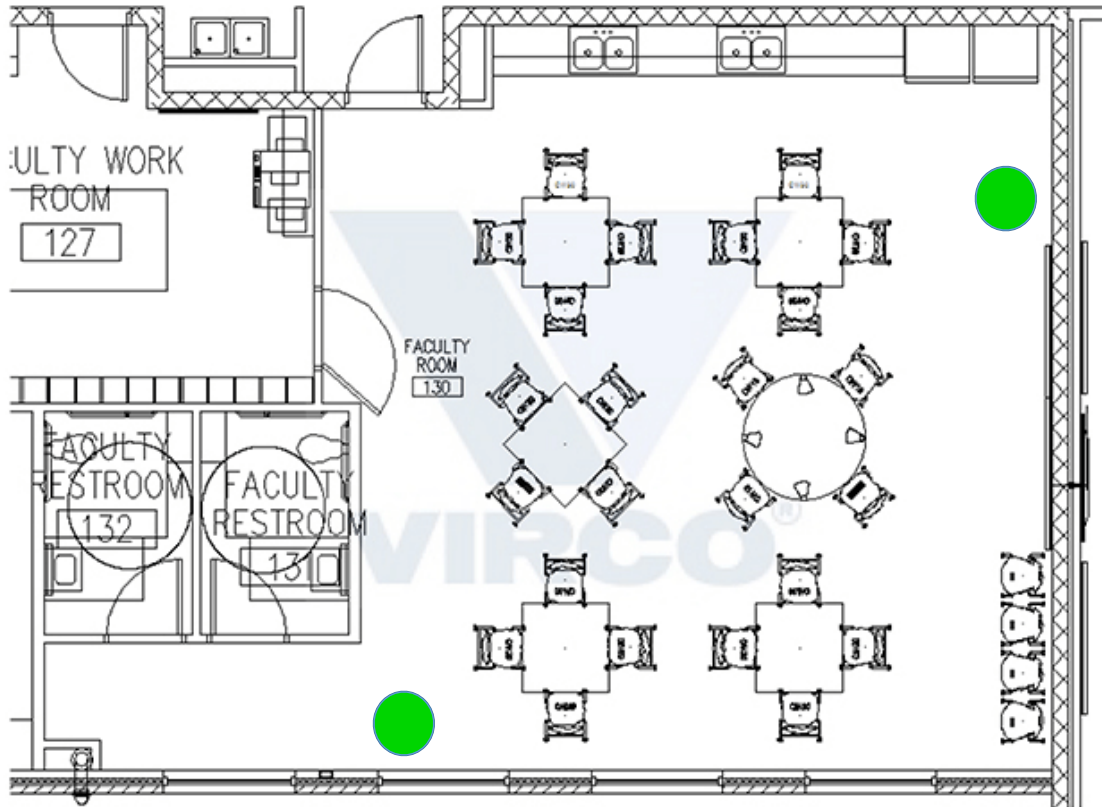

1. Located on opposite corners or sides provides good airflow and coverage of entire lounge area.
2. Not interfering with doors or obstructions.

Teacher Lounge **No!**

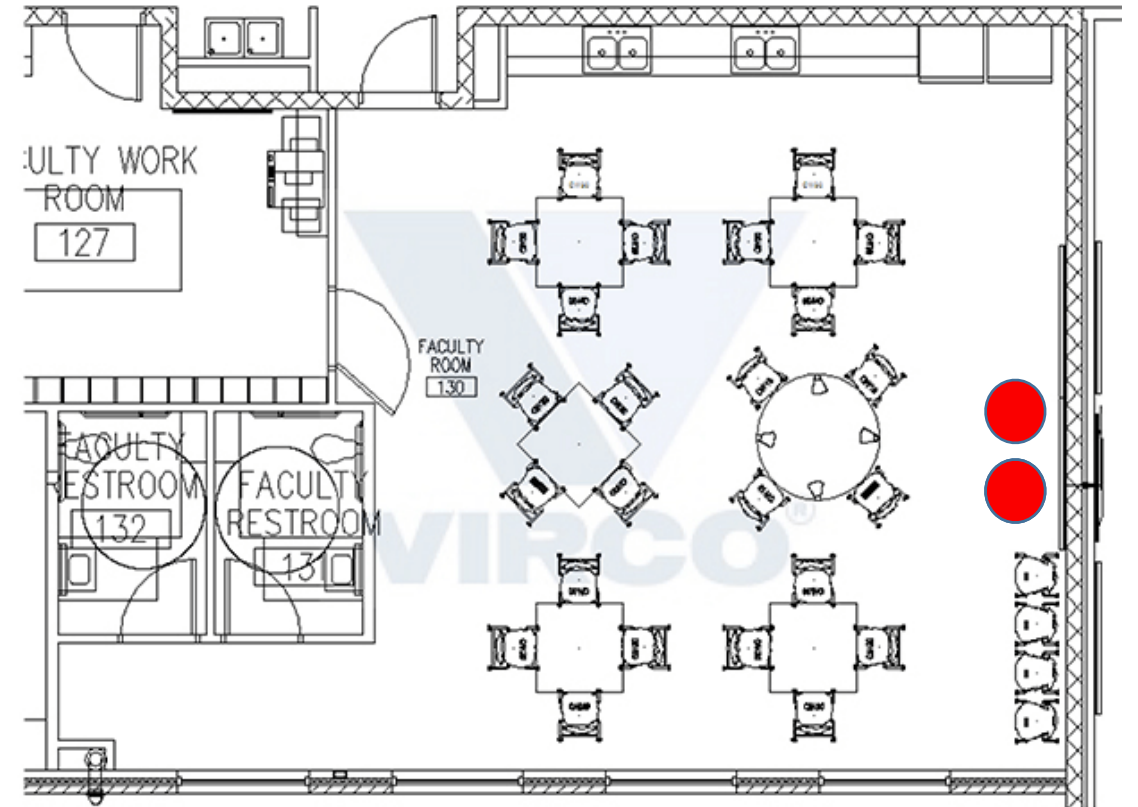
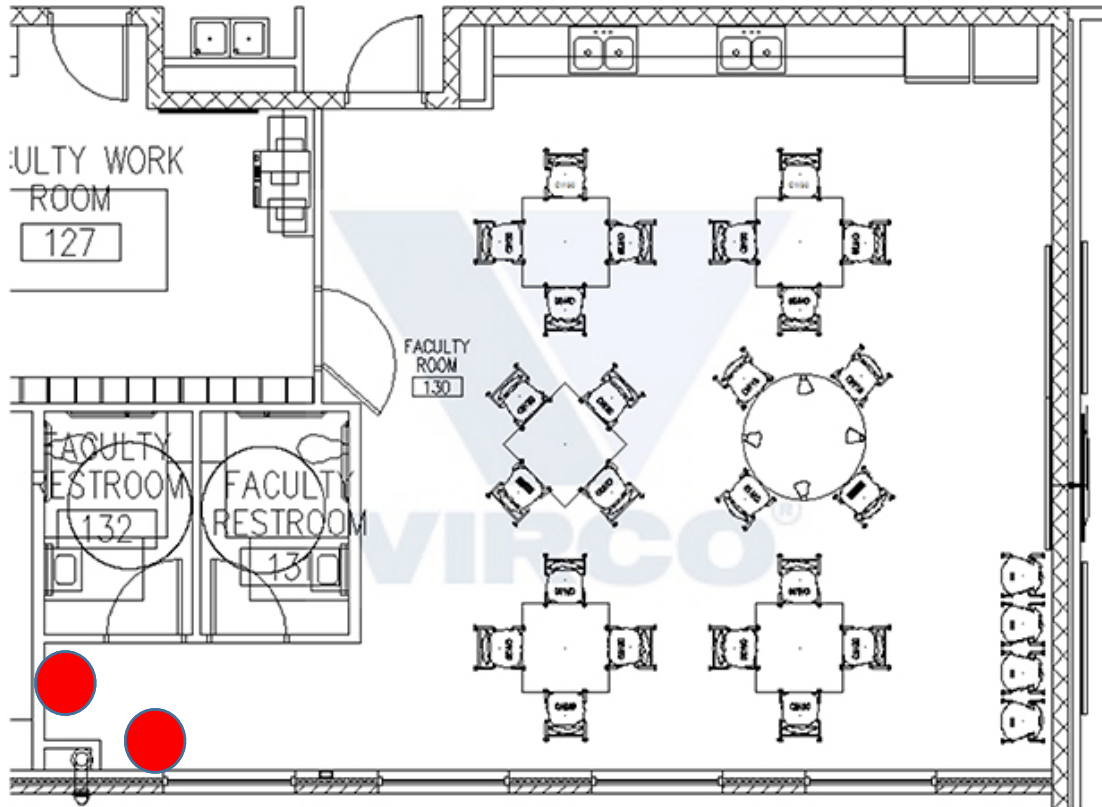

1. Located next to each other or only on one side reduces coverage of entire lounge area.

Music Room Yes!

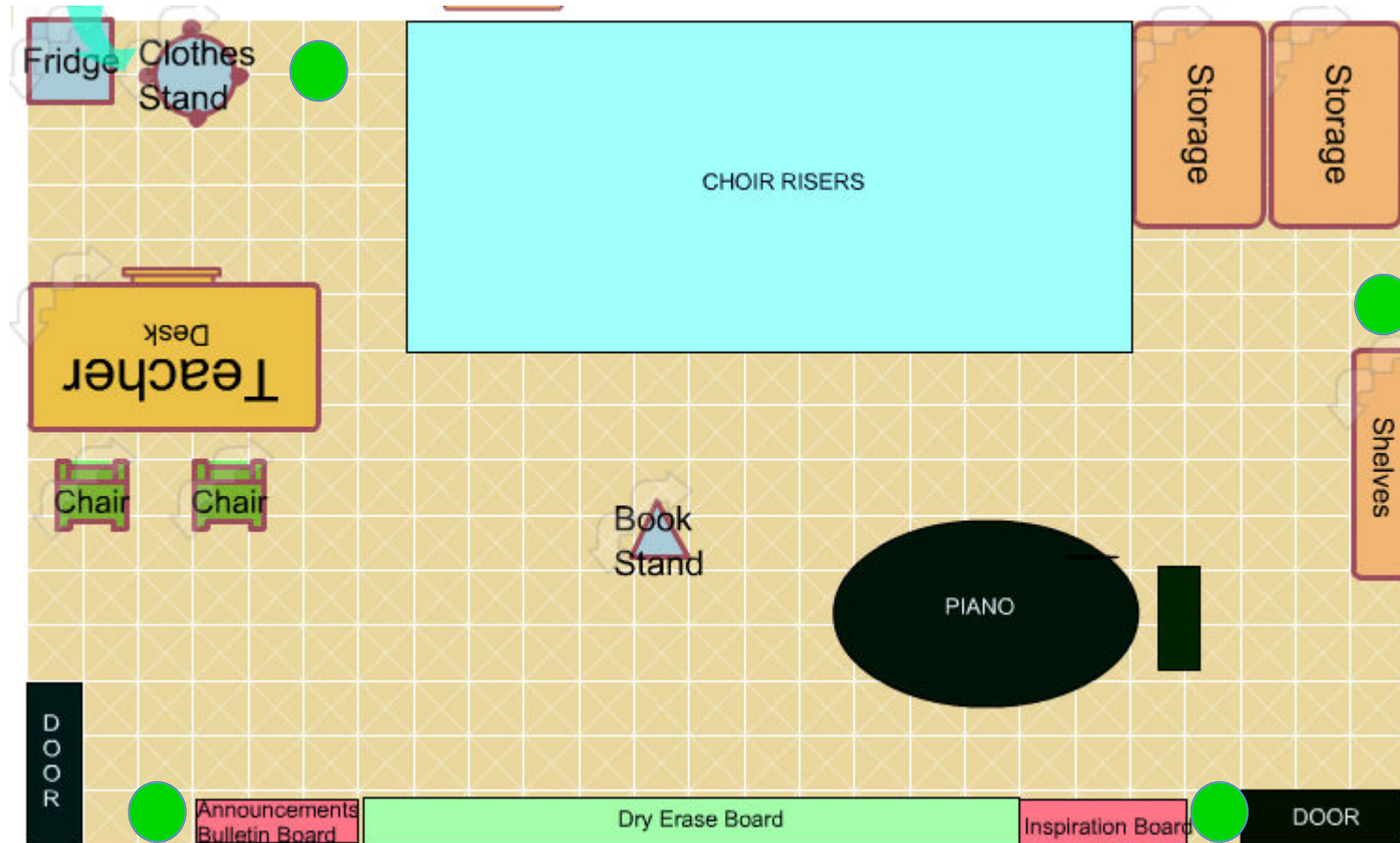

1. Located on opposite corners or sides provides good airflow and coverage of entire classroom.
2. Not interfering with doors or obstructions.

Music Room No!

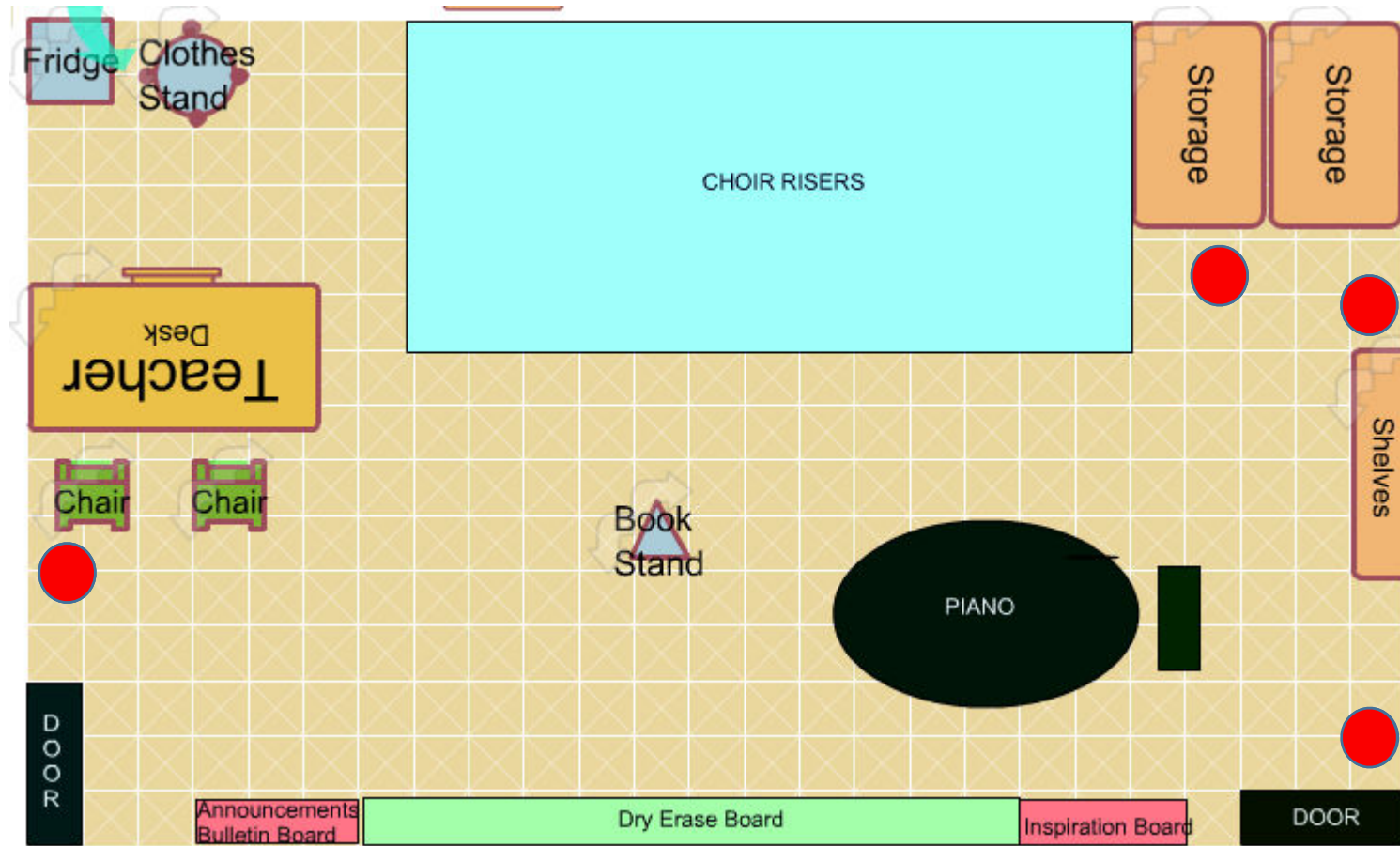

1. Located next to each other or only on one side reduces coverage of entire classroom.
2. Units are blocking access to storage, chairs and doors.

Small Office Yes!

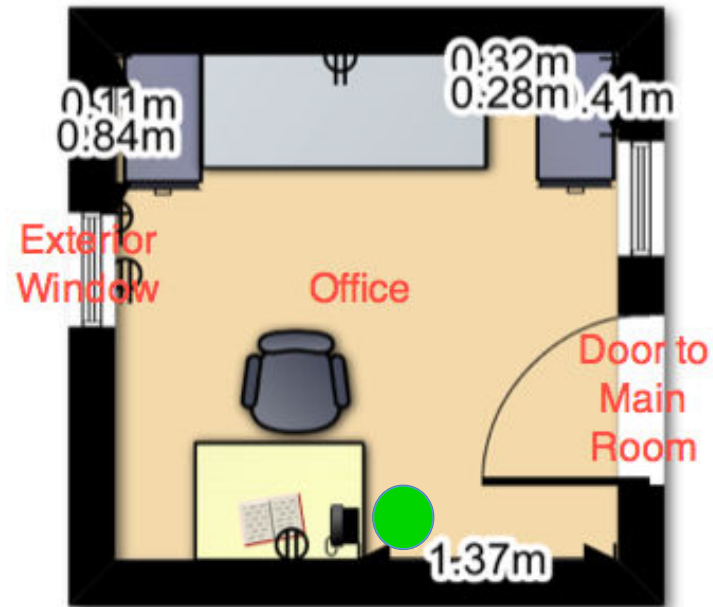

1. Not interfering with doors or obstructions.

Small Office **No!**

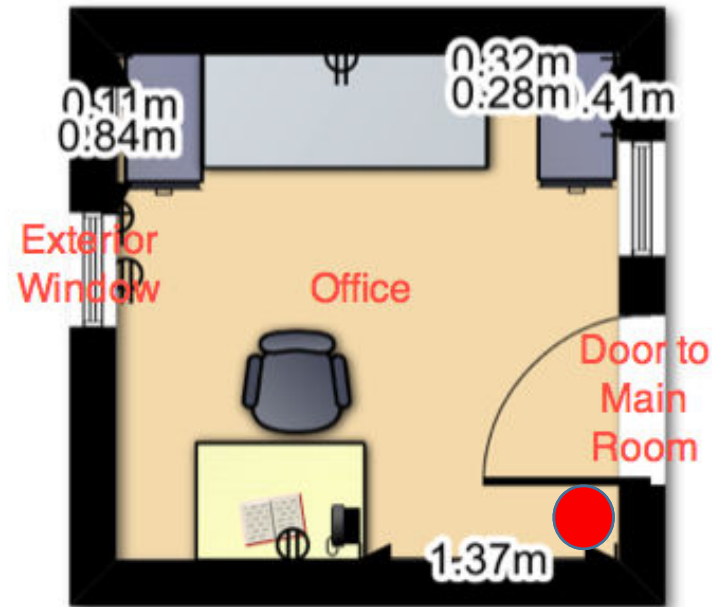

1. Unit airflow is blocked by open door.